

For more information on fan sizing and terminology, see page 4321.

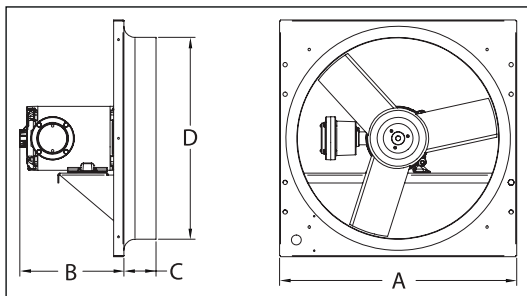

**Panel Exhaust Fan**



**Panel Fan**



**Ring Exhaust Fan**

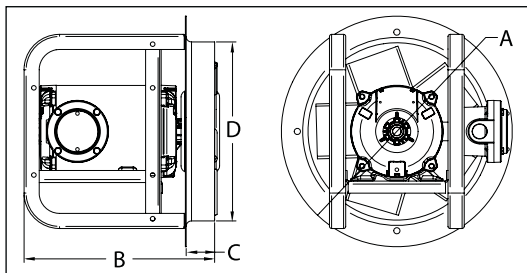

**Ring Fan**

**Hazardous Location Direct-Drive Exhaust Fans**



- Mount: vertical or horizontal
- Motors: explosionproof, fan-cooled enclosure with Class B insulation
- Hazardous location ball bearings
- Max. ambient temp.: 104°F

Fans ventilate spaces containing flammable or explosive vapors, gases, or dusts (per NEC 500). For use with NEC Class I, Division I, Groups C and D; NEC Class II, Division I, Groups F and G (No. 10E020 for Groups E, F, and G). Galvanized frame and finish. Spark-resistant aluminum propellers. Motorized damper and shutters are not recommended. UL and C-UL Listed.

Note: OSHA complying guards are required when a fan is installed within 8 ft. of floor, working level, or within reach of personnel. Not for use with hazardous location exhaust applications. Review OSHA codes and UL standards. See index under Guards, Fan.

Consult local ventilation contractor or fire inspector for local code requirements. Do not use where motor or blades will accumulate paint residue. Electrically ground all components in hazardous location system.

**RING EXHAUST FANS**

Mounting holes are pre-punched for fast and easy installation.

Propeller Dia. (in.)	A (in.)	B (in.)	C (in.)	D (in.)	CFM @ Static Pressure Shown*					Voltage	Phase	Motor HP	Motor RPM	Full Load Amps	Sones @ 0.000" SP @ 5 ft.**	No. of Blades	Item No.	\$ Each		
					0.000"	0.125"	0.250"	0.375"	0.500"											
<b>Panel Exhaust Fans</b>																				
12	16	9½	3	12¼	1347	1262	1142	947	604	115/208-230	1	¼	1750	4.2/2.1-2.0	13.4	5	10D995	✓	1,017.00	
			3¼	16½	1347	1262	1142	947	604	208-230/460	3	¼	1750	1.4-1.3/65	13.4	5	10D996	✓	1,145.00	
16	20		3	16½	2476	2288	2061	1769	1350	115/208-230	1	¼	1750	4.2/2.1-2.0	14.1	3	10D997	✓	1,119.00	
		11	3½	18½	2476	2288	2061	1769	1350	208-230/460	3	¼	1750	1.4-1.3/65	14.1	3	10D998	✓	1,108.00	
18	22		3	18½	3168	2912	2612	2219	1599	115/208-230	1	½	1750	6/3.2-3	19.1	3	10D999	✓	1,247.00	
			3	18½	3168	2912	2612	2219	1599	208-230/460	3	½	1750	1.8-1.6/8	19.1	3	10E001	✓	1,213.00	
20	24	11½	3¾	20½	4557	4254	3919	3542	3101	115/208-230	1	½	1750	7.4/3.9-3.7	23	3	10E002	✓	1,375.00	
			3¾	20½	4557	4254	3919	3542	3101	208-230/460	3	½	1750	1.8-2/1	23	3	10E003	✓	1,515.00	
24	28		3¾	24½	5669	4946	4010	2963	1906	115/208-230	1	½	1750	7.4/3.9-3.7	26	2	10E004	✓	1,459.00	
		12	3¾	24½	5669	4946	4010	2963	1906	208-230/460	3	½	1750	1.8-2/1	26	2	10E006	✓	1,532.00	
			3¾	24½	6317	5851	5314	4729	4117	115/208-230	1	¾	1750	10.6/5.3	28	3	10E005	✓	1,589.00	
			3¾	24½	6317	5851	5314	4729	4117	208-230/460	3	¾	1750	3.2-3/1.5	28	3	10E007	✓	1,686.00	
<b>Ring Exhaust Fans</b>																				
12	16¼	13½	2	12½	1147	999	803	682	—	115/208-230	1	¼	1725	4.2/2.1-2.0	13.6	5	10E008	✓	1,039.00	
				12½	1147	999	803	682	—	208-230/460	3	¼	1725	1.4-1.3/65	13.6	5	10E009	✓	1,165.00	
16	20¼			16½	2153	1943	1713	1366	1125	115/208-230	1	¼	1750	4.2/2.1-2.0	17.0	3	10E010	✓	1,135.00	
				16½	2153	1943	1713	1366	1125	208-230/460	3	¼	1750	1.4-1.3/65	17.0	3	10E011	✓	1,178.00	
18	22¼			18½	2371	2089	1756	1423	1088	115/208-230	1	¼	1750	4.2/2.1-2.0	21	3	10E012	✓	1,198.00	
				18½	2371	2089	1756	1423	1088	208-230/460	3	¼	1750	1.4-1.3/65	21	3	10E013	✓	1,140.00	
20	24¼			20½	2429	2074	1744	1341	1098	115/208-230	1	¼	1750	4.2/2.1-2.0	23	3	10E014	✓	1,144.00	
				20½	2429	2074	1744	1341	1098	208-230/460	3	¼	1750	1.4-1.3/65	23	3	10E015	✓	1,255.00	
				24½	3	3837	3305	2637	1970	—	115/208-230	1	½	1750	6/3.2-3	30	3	10E016	✓	1,429.00
					3	3837	3305	2637	1970	—	208-230/460	3	½	1750	1.8-1.6/8	30	3	10E018	✓	1,451.00
24	28¼				3	5669	4946	4010	2963	1906	115/208-230	1	½	1750	7.4/3.9-3.7	26	2	10E017	✓	1,522.00
				30½	3	5669	4946	4010	2963	1906	208-230/460	3	½	1750	1.8-2/1	26	2	10E019	✓	1,488.00
30	34¼	17½	8153		7515	6804	5957	4956	115/208-230	1	¾	1140	9.2/5-4.6	28	3	10E020	✓	1,787.00		

\* Performance certified is for installation type A: free inlet, free outlet. Performance ratings do not include the effects of appurtenances (accessories). Speed (rpm) shown is nominal. Performance is based on actual speed of test. \*\* The sound ratings shown are loudness values in fan sones at 5 ft. (1.5m), in a hemispherical free field calculated per AMCA Standard 301. Values shown are for installation type A: free inlet hemispherical sone levels.



**Hazardous Location Direct-Drive Exhaust Fans**

Vertical-mount fans require little maintenance and are easy to install. All models feature a totally enclosed, ball bearing motor with thermal overload protection. The fan blades are constructed of well-balanced, heavy-gauge aluminum. Designed with a rugged steel welded box housing that has a durable, powder-coated finish. The aluminum louver shutters are supported by long life nylon bushings. Heavy wire chrome-plated OSHA guards provide protection on intake side of fan. All fans are shipped assembled.

Propeller Dia. (in.)	CFM @ Static Pressure Shown		Voltage	Phase	Motor HP	Motor RPM	Full Load Amps	No. of Blades	Item No.	\$ Each	
	0.000"	0.250"									
12	1640	1390	115/208-230	1	½	1625	6.6/3.1-3.3	3	23N613	✓	1,143.00
18	3200	2920	115/208-230	1	½	1625	6.6/3.1-3.3	3	23N614	✓	1,299.00
24	5500	5100	115/208-230	1	½	1625	6.6/3.1-3.3	3	23N615	✓	1,380.00