

For more information on fan sizing and terminology, see page 4321.

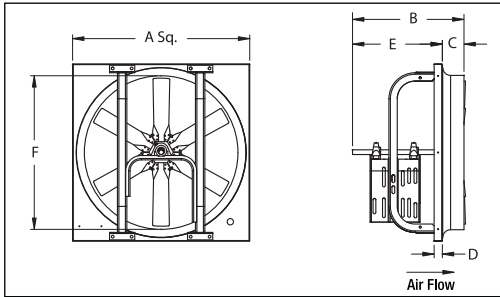

No. 3FKD7



Standard-Duty Belt-Drive Exhaust Fans



- Mount: exhaust—vertical, supply—horizontal
- Regreasable pillow block ball bearings, except Nos. 3FKD7 and 1WDB9 have sealed pillow block
- Max. inlet/ambient temp.: 104°F
- Variable pitch, adjustable motor pulley optimizes fan performance

Designed for commercial applications requiring high volumes of air at low static pressures. Fans feature 6-blade galvanized-steel propellers, rigid drive-frame rails, and 1-pc. motor/bearing plate. Air handling-quality bearings meet a minimum of L10-100,000 hours. Motor, sheaves, bushings, and belts are packed separately when complete fan with drive package is ordered. UL and C-UL Listed.

Note: OSHA complying guards are required when a fan is installed within 8 ft. of floor, working level, or within reach of personnel. Review OSHA codes and UL standards. See Index under Guards, Fan.

RECOMMENDED ACCESSORIES

Propeller Dia. (in.)	A	B	Dimensions (in.)			E	F	Wall Housing	Weather	Wall	Fan	Galvanized	Aluminum	Fiberglass
			C	D	Item No.			Hood Item No.	Collar Item No.	Guard Item No.	Item No.	Item No.	Item No.	
20	24	19½	¾	1	16¼	20½	3FKF7	3FKF2	3FKF3	1WBU2	1C745	4C559	5C214	
24	28	18	4%	1	13%	24%	3FKF8	1WBV9	1WBV1	1WBUB3	1C746	3C308	5C215	
30	34	21½	5¼	1	16¼	30%	3FKF9	1WBW1	1WBV2	1WBUB4	1C055	3C309	5C216	
36	40	22	6	1	16	36%	3FKG1	1WBW2	1WBV3	1WBUB5	4C521	3C310	5C217	
42	46	23½	6	2	17½	42½	3FKG2	1WBW3	1WBV4	1WBUB6	1C210	3C311	5C219	
48	54	23½	7	2	16½	48½	3FKG3	1WBW4	1WBV5	1WBUB7	1C211	3C312	5C220	

FANS COMPLETE WITH DRIVE PACKAGE**

Prop. Dia. (in.)	CFM Air Delivery @ Static Pressure Shown*				Motor HP	Fan RPM	Sones @ 5 ft. #	Max. BHP†	Open Dripproof 1-Phase Motor 115/230V, 60 Hz		Totally Enclosed 1-Phase Motor 115/230V, 60 Hz		Open Dripproof 3-Phase Motor 208-230/460V, 60 Hz		Totally Enclosed 3-Phase Motor 208-220/440V, 60 Hz		FAN WITHOUT MOTOR & DRIVE PKG. **		
	0.000"	0.125"	0.250"	0.375"					Item No.	\$ Each	Item No.	\$ Each	Item No.	\$ Each	Item No.	\$ Each	Item No.	\$ Each	No.
20	3581	3148	2469	1160	¼	953	16.2	0.30	7AD16	749.00	7AD18	827.50	7AD17	810.50	7AD19	855.50	3FKD7	✓	473.25
	3904	3517	2954	2037	½	1039	17.2	0.40	7AD20	747.50	7AD22	811.50	7AD21	794.00	7AD23	864.50			
	4587	4277	3873	3333	¾	1221	20	0.60	7AD24	795.00	7AD26	825.00	7AD25	827.00	7AD27	889.00			
	4826	4312	3570	—	1	923	17.3	0.30	7CC73	781.00	7CC74	877.50	7AD28	842.00	7CC75	874.00			
24	5292	4830	4207	—	½	1012	21	0.39	7CC76	775.50	7CC77	861.50	7AD29	822.00	7CC78	870.00	1WDB9	✓	501.50
	6175	5789	5337	—	¾	1181	24	0.60	7CC79	886.50	7CC80	905.00	7AD30	880.00	7CC81	914.00			
	7069	6732	6372	5917	1	1352	30	0.90	7CC82	927.00	7CC83	1,008.00	7AD31	911.50	7CC84	941.50			
	7096	6015	—	—	¼	621	13.2	0.30	7CC85	870.50	7CC86	967.50	7AD32	931.50	7CC87	963.50			
30	7713	6763	5160	—	½	675	14.6	0.39	7CC88	885.00	7CC89	971.00	7AD33	932.50	7CC90	979.50	1WDC1	✓	566.50
	8867	8036	6990	—	¾	776	17.8	0.60	7CC91	950.50	7CC92	969.00	7AD34	944.00	7CC93	978.00			
	10,078	9342	8560	7424	1	882	22	0.90	7CC94	996.50	7CC95	1,078.00	7AD35	981.00	7CC96	1,011.00			
	11,061	10,385	9736	8847	1	968	26	1.20	7CC97	1,006.00	7CC98	1,095.00	7AD36	1,094.00	7CC99	1,137.00			
36	10,484	8176	—	—	½	477	12.5	0.39	7CF01	991.00	7CF02	1,077.00	7AD37	1,038.00	7CF03	1,086.00	1WDC2	✓	575.50
	12,220	10,328	—	—	¾	556	15.8	0.60	7CF04	991.50	7CF05	1,010.00	7AD38	985.00	7CF06	1,019.00			
	13,802	12,156	10,205	—	1	628	18.7	0.90	7CF07	1,030.00	7CF08	1,111.00	7AD39	1,014.00	7CF09	1,044.00			
	15,253	13,798	12,111	9875	1	694	21	1.20	7CF10	1,042.00	7CF11	1,131.00	7AD40	1,128.00	7CF12	1,173.00			
42	17,407	16,198	14,753	13,170	1½	792	28	1.80	7CF13	1,152.00	7CF14	1,249.00	7AD41	1,132.00	7CF15	1,177.00	1WDC3	✓	732.00
	14,712	11,980	—	—	¾	426	17.1	0.60	7CF16	1,221.00	7CF17	1,239.00	7AD42	1,214.00	7CF18	1,248.00			
	16,646	14,327	10,507	—	1	482	20	0.90	7CF19	1,210.00	7CF20	1,291.00	7AD43	1,195.00	7CF21	1,225.00			
	18,408	16,388	13,752	—	1	533	22	1.20	7CF22	1,230.00	7CF23	1,318.00	7AD44	1,316.00	7CF24	1,361.00			
48	20,998	19,302	17,182	14,193	1½	608	26	1.80	7CF25	1,331.00	7CF26	1,428.00	7AD45	1,311.00	7CF27	1,356.00	1WDC4	✓	868.50
	17,349	13,047	—	—	¾	341	13.1	0.60	7CF31	1,442.00	7CF32	1,461.00	7AD46	1,436.00	7CF33	1,470.00			
	19,995	16,655	—	—	1	393	16.4	0.90	7CF34	1,472.00	7CF35	1,553.00	7AD47	1,456.00	7CF36	1,487.00			
	21,827	18,907	13,506	—	1	429	19.4	1.20	7CF37	1,399.00	7CF38	1,488.00	7AD48	1,486.00	7CF39	1,530.00			
48	24,981	22,460	19,129	—	1½	491	22	1.80	7CF40	1,499.00	7CF41	1,597.00	7AD49	1,480.00	7CF42	1,525.00	1WDC4	✓	868.50
	27,474	25,206	22,529	18,065	2	540	25	2.40	7CF43	1,505.00	7CF44	1,648.00	7AD50	1,561.00	7CF45	1,614.00			
	31,442	29,484	27,395	24,703	3	618	29	3.60	—	—	—	—	7AD51	1,695.00	7D529	1,632.00			
	—	—	—	—	—	—	—	—	—	—	—	—	—	—	—	—			

* Performance certified is for installation type A: free inlet, free outlet. † Power rating (BHP) does not include transmission losses. Performance ratings do not include the effects of aperturancs (accessories). # The sound ratings shown are loudness values in fan sones at 5 ft. (1.5m) in a hemispherical free field calculated per AMCA Standard 301. Values are for installation type A: free inlet hemispherical sone levels. ** Drive package consists of appropriate motor, belt, and sheaves to obtain performance listed.



Grainger TripleGuard®
Repair or Replacement Coverage Plans
Proud to Protect Your Purchases

Receive repairs or replacement of your covered product for up to two years beyond the Grainger one-year warranty for covered failures.

Visit grainger.com/tripleguard for coverage details.