

Reversible Belt-Drive Exhaust/Supply Fan

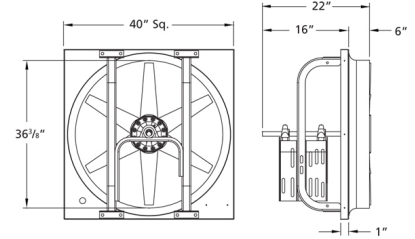

Designed for commercial and industrial applications requiring both exhaust and supply air. Construction includes rigid drive frame rails and one-piece motor/bearing plate. Propeller utilizes a six-blade cast aluminum design which provides low sound levels. Fans may be mounted either in the horizontal or vertical positions.

- Variable pitch adjustable motor pulley to optimize fan performance
- Maximum inlet air temperature: 104° F
- 6-Blade heavy-duty cast aluminum propellers



Performance Characteristics

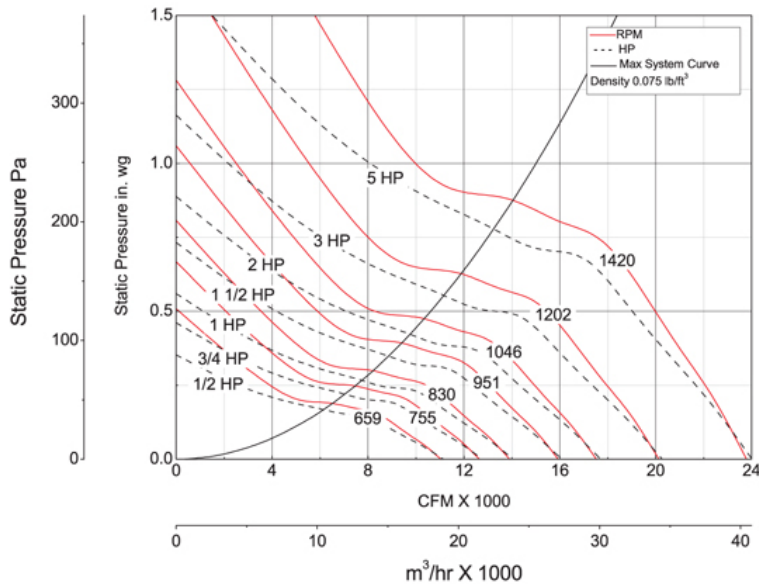

Construction Features

Impeller Diameter (Typ.)	36 in
Impeller Type	Propeller
Impeller Material	Cast Aluminum
Number of Blades	6
Max Inlet Temp	104 °F
Bearing Type	Regreaseable Cast Pillow Block
Drive Package Description	Drives By Others
Warranty Length	1 Year

Air & Sound Performance

Motor HP	Max BHP	Fan RPM	CFM @	0.000" SP	0.125" SP	0.250" SP	0.375" SP	0.500" SP	0.625" SP	0.750" SP
1/2	0.57	659	CFM	11,037	8967	—	—	—	—	—
			Sones	18.1	19.4	—	—	—	—	—
3/4	0.85	755	CFM	12,645	10,874	—	—	—	—	—
			Sones	22.0	23.0	—	—	—	—	—
1	1.13	830	CFM	13,901	12,316	10,429	—	—	—	—
			Sones	26.0	26.0	28.0	—	—	—	—
1 1/2	1.79	951	CFM	15,927	14,602	13,074	10,104	—	—	—
			Sones	30.0	31.0	32.0	33.0	—	—	—
2	2.26	1046	CFM	17,519	16,359	14,955	13,436	—	—	—
			Sones	35.0	35.0	36.0	38.0	—	—	—
3	3.45	1202	CFM	20,131	19,149	17,957	16,757	15,384	—	—
			Sones	45.0	45.0	45.0	46.0	48.0	—	—
5	5.75	1420	CFM	23,782	22,951	22,043	20,995	19,985	18,886	17,939
			Sones	64.0	64.0	64.0	64.0	66.0	68.0	68.0

Performance is for exhaust fans installation type A: Free inlet, Free outlet. Supply fans performance is approximately 20% less for each horsepower (HP). Power rating (BHP) does not include transmission losses. Performance ratings do not include the effects of appurtenances (accessories). The sound ratings shown are loudness values in fan sones at 5 ft. (1.5 m) in a hemispherical free field. Values are for installation type A: Free inlet sone levels.