

## Reversible Belt-Drive Exhaust/Supply Fan

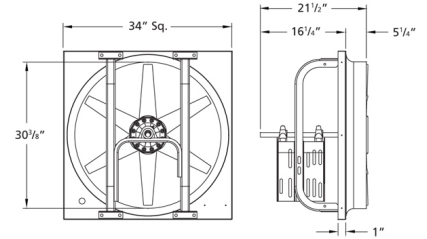

Designed for commercial and industrial applications requiring both exhaust and supply air. Construction includes rigid drive frame rails and one-piece motor/bearing plate. Propeller utilizes a six-blade cast aluminum design which provides low sound levels. Fans may be mounted either in the horizontal or vertical positions.

- Variable pitch adjustable motor pulley to optimize fan performance
- Maximum inlet air temperature: 104° F
- 6-Blade heavy-duty cast aluminum propellers



## Performance Characteristics

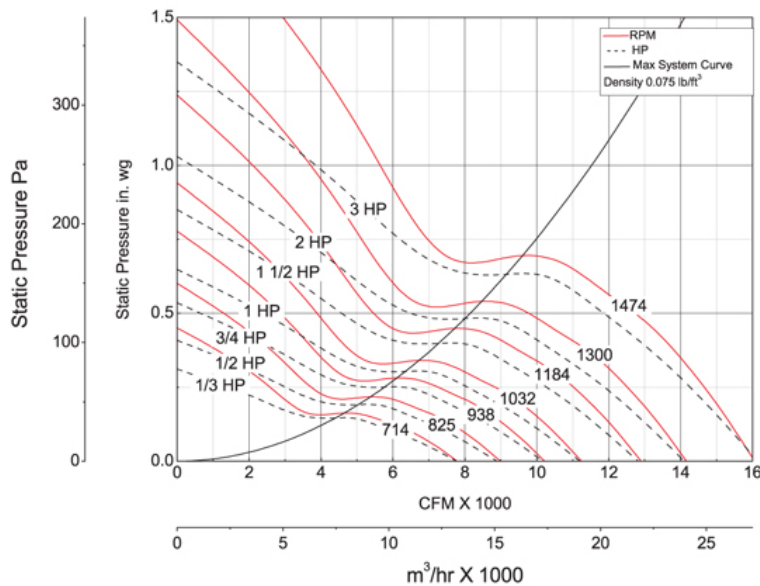

## Construction Features

Impeller Diameter (Typ.)	30 in
Impeller Type	Propeller
Impeller Material	Cast Aluminum
Number of Blades	6
Max Inlet Temp	104 °F
Bearing Type	Regreaseable Cast Pillow Block
Drive Package Description	Drives By Others
Warranty Length	1 Year

## Air & Sound Performance

Motor HP	Max BHP	Fan RPM	CFM @	0.000" SP	0.125" SP	0.250" SP	0.375" SP	0.500" SP	0.625" SP
1/3	0.38	714	CFM	7780	5978	—	—	—	—
			Sones	15.9	16.6	—	—	—	—
1/2	0.58	825	CFM	8989	7614	—	—	—	—
			Sones	18.7	19.4	—	—	—	—
3/4	0.86	938	CFM	10,221	9081	7219	—	—	—
			Sones	23.0	23.0	23.0	—	—	—
1	1.15	1032	CFM	11,245	10,228	8817	—	—	—
			Sones	26.0	27.0	28.0	—	—	—
1 1/2	1.73	1184	CFM	12,901	12,043	10,999	9470	—	—
			Sones	31.0	32.0	33.0	32.0	—	—
2	2.30	1300	CFM	14,165	13,400	12,516	11,379	9727	—
			Sones	36.0	37.0	37.0	40.0	37.0	—
3	3.45	1474	CFM	16,061	15,386	14,640	13,790	12,704	11,249
			Sones	45.0	46.0	45.0	48.0	50.0	49.0

Performance is for exhaust fans installation type A: Free inlet, Free outlet. Supply fans performance is approximately 20% less for each horsepower (HP). Power rating (BHP) does not include transmission losses. Performance ratings do not include the effects of appurtenances (accessories). The sound ratings shown are loudness values in fan sones at 5 ft. (1.5 m) in a hemispherical free field. Values are for installation type A: Free inlet sone levels.