

## Reversible Belt-Drive Exhaust/Supply Fan

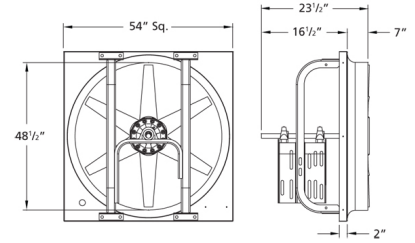

Designed for commercial and industrial applications requiring both exhaust and supply air. Construction includes rigid drive frame rails and one-piece motor/bearing plate. Propeller utilizes a six-blade cast aluminum design which provides low sound levels. Fans may be mounted either in the horizontal or vertical positions.

- Variable pitch adjustable motor pulley to optimize fan performance
- Maximum inlet air temperature: 104° F
- 6-Blade heavy-duty cast aluminum propellers



### Performance Characteristics

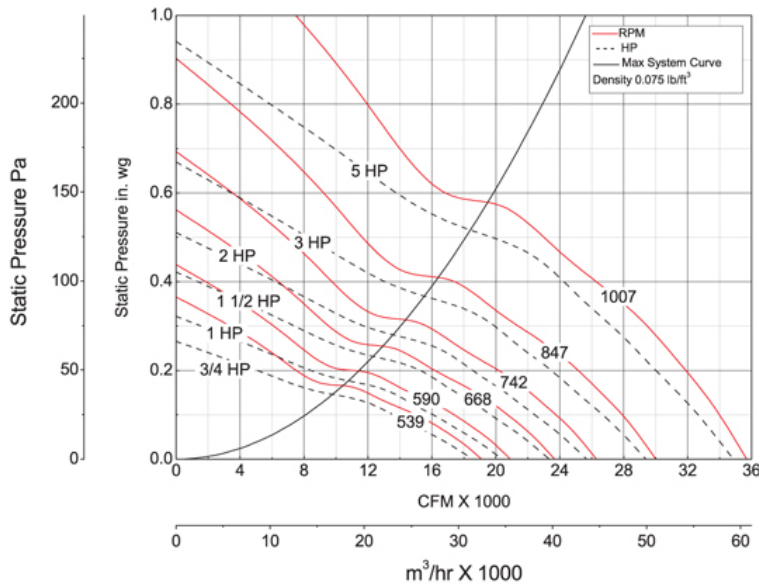

### Construction Features

<b>Impeller Diameter (Typ.)</b>	48 in
<b>Impeller Type</b>	Propeller
<b>Impeller Material</b>	Cast Aluminum
<b>Number of Blades</b>	6
<b>Max Inlet Temp</b>	104 °F
<b>Bearing Type</b>	Regreaseable Cast Pillow Block
<b>Drive Package Description</b>	Drives By Others
<b>Warranty Length</b>	1 Year

### Air & Sound Performance

Motor HP	Max BHP	Fan RPM	CFM @	0.000" SP	0.125" SP	0.250" SP	0.375" SP	0.500" SP
3/4	0.86	539	CFM	19,105	13,420	—	—	—
			Sones	22.0	23.0	—	—	—
1	1.15	590	CFM	20,913	16,100	—	—	—
			Sones	25.0	27.0	—	—	—
1 1/2	1.73	668	CFM	23,678	19,795	13,596	—	—
			Sones	31.0	32.0	33.0	—	—
2	2.30	742	CFM	26,301	22,968	17,867	—	—
			Sones	37.0	38.0	40.0	—	—
3	3.45	847	CFM	30,022	27,229	23,404	18,372	—
			Sones	44.0	46.0	50.0	51.0	—
5	5.75	1007	CFM	35,694	33,508	30,682	27,130	22,884
			Sones	61.0	62.0	64.0	68.0	66.0

Performance is for exhaust fans installation type A: Free inlet, Free outlet. Supply fans performance is approximately 20% less for each horsepower (HP). Power rating (BHP) does not include transmission losses. Performance ratings do not include the effects of appurtenances (accessories). The sound ratings shown are loudness values in fan sones at 5 ft. (1.5 m) in a hemispherical free field. Values are for installation type A: Free inlet sone levels.