

Utility Exhaust Belt-Drive Blower



Designed for commercial kitchen exhaust or industrial spark resistant applications requiring high volumes of air at high static pressures. Suitable for ducted exhaust, supply or return-air applications. Constructed out of heavy gauge steel with polyester gray coating. The scroll is welded, has a bolted access door and 1 inch threaded drain connection for easy cleaning.

- Maximum inlet air temperature: 300° F
- UL/cUL 762 Listed for Restaurant Exhaust Appliances
- Polyester gray coating
- Backward incline nonoverloading aluminum wheel
- Aluminum rub ring
- Bolted access door

AMCA Air



Dayton Electric Mfg. Co. certifies that the blowers shown herein are licensed to bear the AMCA seal. The ratings shown are based on tests and procedures performed in accordance with AMCA Publication 211 and comply with the requirements of the AMCA Certified Ratings Program.

UL/cUL 762



E53236
MH12596

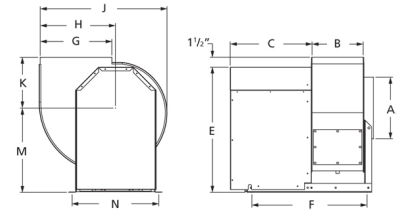

A	B	C	E	F	G
11 in	9 3/4 in	15 1/2 in	22 1/4 in	21 7/8 in	11 1/4 in
H	J	K	M	N	
11 1/2 in	20 1/8 in	8 5/8 in	15 1/8 in	16 in	

Performance Characteristics

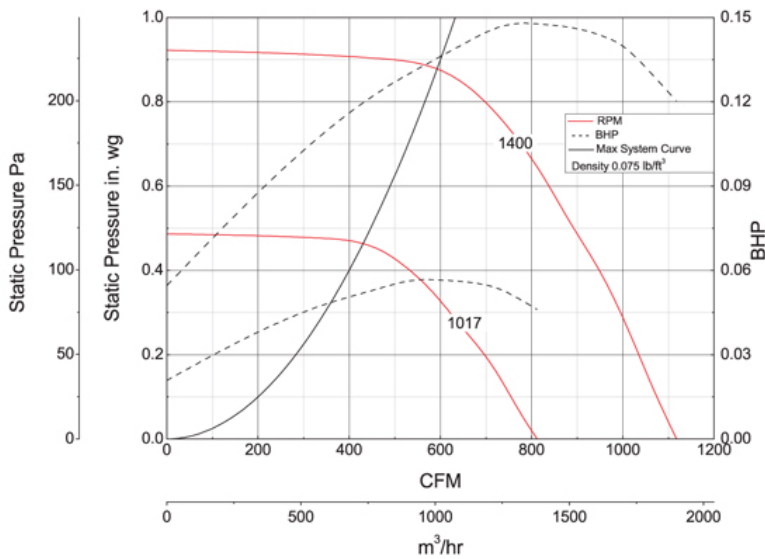

Construction Features

Impeller Diameter (Typ.)	11 1/8 in
Impeller Type	Backward Inclined Centrifugal
Impeller Material	Aluminum
Max Inlet Temp	300 °F
Bearing Type	Ball
Drive Package Description	Drives Packaged Separately
Warranty Length	1 Year

Motor Information

Motor Item Number	3K091
Voltage	115/208-230
Hertz (Cycle)	60 Hz
Motor Phase	1
Motor Enclosure	Open Drip Proof
RPM	1,725 rpm
Full Load Amps	4.6/2.2-2.3

Other Components

Component	Description	Item #
Fan Description	Exhaust Fan	488V76
Belt	4L290 (QTY: 1)	4L290
Driver Sheave	1VP3412	5UHP9
Driven Sheave	AK4134	5RJC2

Air & Sound Performance

Motor HP	Max BHP	Fan RPM	CFM @	0.000" SP	0.125" SP	0.250" SP	0.375" SP	0.500" SP	0.625" SP	0.750" SP	0.875" SP
1/4	0.15	1400	CFM	1118	1065	1015	960	893	824	737	564
			Sones	9.3	9.0	8.7	8.4	8.0	7.7	7.4	7.1

Performance certified is for installation type B: Free inlet, Ducted outlet. Power rating (BHP) does not include transmission losses. Performance ratings do not include the effects of appurtenances (accessories). The AMCA Certified ratings Seal applies to air performance ratings only.

Catalog 405, July 2014

Operating Range of Drive Package

Turns Open	FRPM @ 0 TO	FRPM @ 1/2 TO	FRPM @ 1 TO	FRPM @ 1 1/2 TO	FRPM @ 2 TO	FRPM @ 2 1/2 TO	FRPM @ 3 TO	FRPM @ 3 1/2 TO	FRPM @ 4 TO	FRPM @ 4 1/2 TO	FRPM @ 5 TO
Approx. FRPM	1400	1381	1336	1290	1245	1199	1153	1108	1062	1017	—